



Rewireable C13 IEC Lock+ Connector

Technical, Safety, and Installation Details

Please read the following information carefully before commencing installation.

Before commencing any electrical work, to prevent the possibility of receiving an electric shock, ensure the mains isolator on the consumer unit / fuse board is in the 'OFF' Position.

This product is rated to 10A (EU), 15A (USA/Canada) at 250V~ 50Hz and 60Hz.

To access the terminations, first remove fixing screws (Fig. 1.), remove the outer housing (Fig. 2.), and then remove the cable clamp (Fig. 3.).

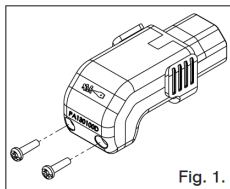

Fig. 1.

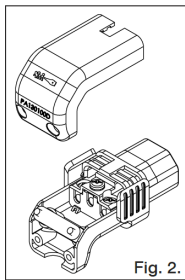

Fig. 2.

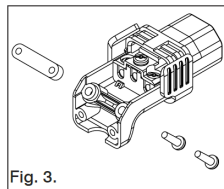

Fig. 3.

Wire the cable into the terminal (Fig. 4.) ensuring correct polarity and nominal torques values are observed (0.4Nm).

Strip cable outer jacket to length (ensuring GROUND is longer than HOT/LIVE and NEUTRAL).

- Both HOT/LIVE and NEUTRAL = 18mm (11/16")
- EARTH (Ground) = 23mm (15/16")

Color Code Chart

	NA	CEE
N - NEUTRAL	White	Light Blue
L - LIVE	Black	Brown
G - GROUND	Green or Green/Yellow	Green/Yellow

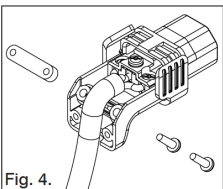

Fig. 4.

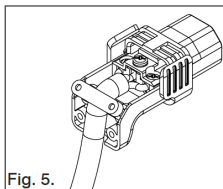

Fig. 5.

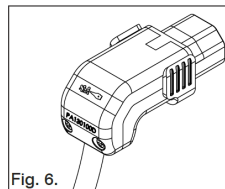
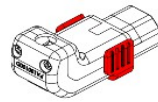

Fig. 6.

Replace the cord grip (Fig. 4 & 5.) ensuring the torque value is achieved (0.3Nm), and then replace the outer housing and screws (Fig. 6.).



Rewireable C13 IEC Lock+ Connector

Technical, Safety, and Installation Details

Please read the following information carefully before commencing installation.

Before commencing any electrical work, to prevent the possibility of receiving an electric shock, ensure the mains isolator on the consumer unit / fuse board is in the 'OFF' Position.

This product is rated to 10A (EU), 15A (USA/Canada) at 250V~ 50Hz and 60Hz.

To access the terminations, first remove fixing screws (Fig. 1.), remove the outer housing (Fig. 2.), and then remove the cable clamp (Fig. 3.).

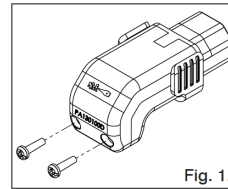

Fig. 1.

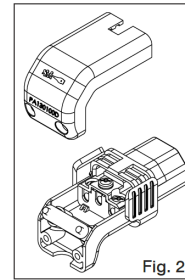

Fig. 2.

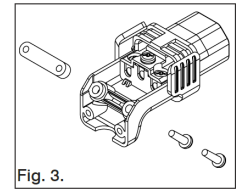

Fig. 3.

Wire the cable into the terminal (Fig. 4.) ensuring correct polarity and nominal torques values are observed (0.4Nm).

Strip cable outer jacket to length (ensuring GROUND is longer than HOT/LIVE and NEUTRAL).

- Both HOT/LIVE and NEUTRAL = 18mm (11/16")
- EARTH (Ground) = 23mm (15/16")

Color Code Chart

	NA	CEE
N - NEUTRAL	White	Light Blue
L - LIVE	Black	Brown
G - GROUND	Green or Green/Yellow	Green/Yellow

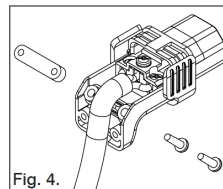

Fig. 4.

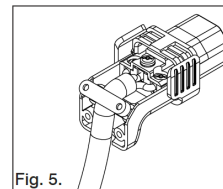

Fig. 5.

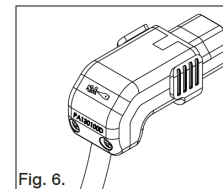
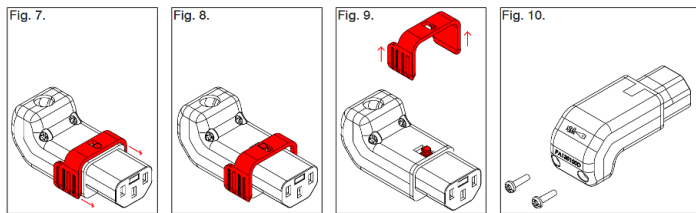

Fig. 6.

Replace the cord grip (Fig. 4 & 5.) ensuring the torque value is achieved (0.3Nm), and then replace the outer housing and screws (Fig. 6.).

CHANGING THE ORIENTATION to UP or DOWN

1. Remove the handle from the connector by sliding forward and pulling away from the connector (Fig. 7, 8 & 9.).
2. Remove fixing screws from housing (Fig. 10.).



3. Remove the top and bottom outer housing (Fig. 11.).
4. Switch orientation and replace outer housing. The top housing should now be on the bottom and vice versa (Fig. 12 & 13.).
5. Once the outer housing has been replaced, the handle can be replaced (Fig. 14.).

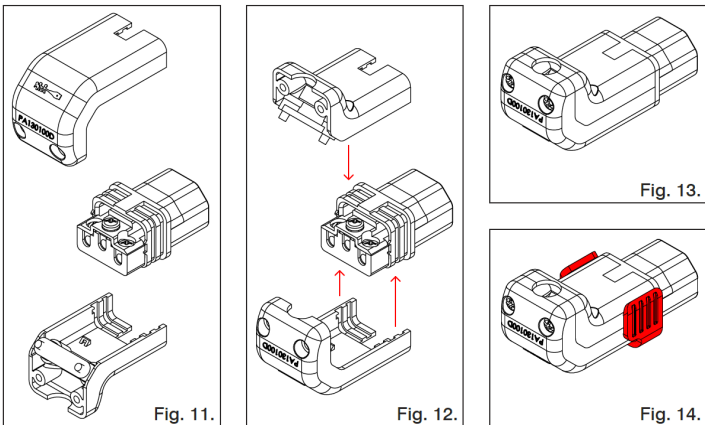

250V

CSA C22.2 No. 60320-1-11. Standard for Appliance Couplers for Household and Similar General Purposes - Part 1: General Requirements - Edition 1 - Issue Date 05/12/2011

UL 60320-1 Appliances Couplers for Similar General Purposes - Part 1: General Requirements - Edition 2 - Issue Date 05/12/2011

IEC 60320-2-2:1998 (2nd Edition) used in conjunction with IEC 60320-1:2001 (2nd Edition)

EN 60320-2-2:1998 (2nd Edition) used in conjunction with EN 60320-2:2001

SYSTEM DESCRIPTION

Screw-In Terminals – This product is designed to be used in accordance with cords with rating no higher than that of the product itself. The nominal torque value for the terminal screws = 0.4Nm. The strain relief clamping screws should be tightened to 0.3Nm (2.65in-lbs).

INSERTION AND REMOVAL

It is essential for maintaining the service life of the product, specifically the locking blade and its locking properties that the following is adhered to.

Before inserting / removing the connector from a C13 socket, the locking blade mechanism must be disengaged by fully retracting the RED handle (Fig. 16.) (Fig. 17.).

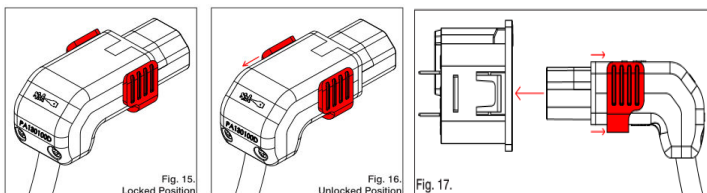

WebberElectronics®

38887 Taylor Pkwy, N. Ridgeville, OH 44039
440.327.7200

IECLock@WebberElectronics.com
WebberElectronics.com

CHANGING THE ORIENTATION to UP or DOWN

1. Remove the handle from the connector by sliding forward and pulling away from the connector (Fig. 7, 8 & 9.).
2. Remove fixing screws from housing (Fig. 10.).

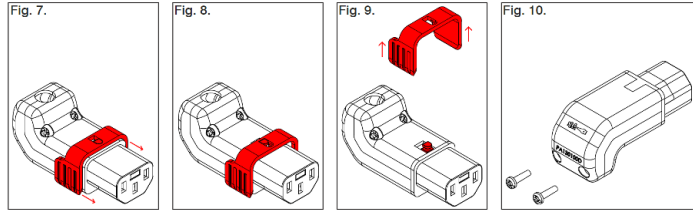

3. Remove the top and bottom outer housing (Fig. 11.).
4. Switch orientation and replace outer housing. The top housing should now be on the bottom and vice versa (Fig. 12 & 13.).
5. Once the outer housing has been replaced, the handle can be replaced (Fig. 14.).

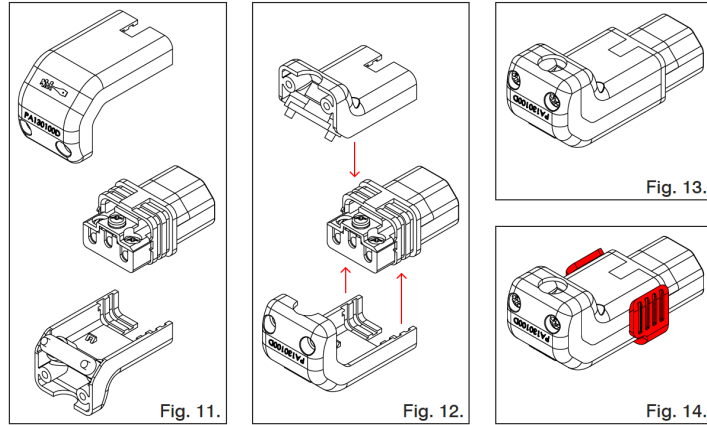

250V

CSA C22.2 No. 60320-1-11. Standard for Appliance Couplers for Household and Similar General Purposes - Part 1: General Requirements - Edition 1 - Issue Date 05/12/2011

UL 60320-1 Appliances Couplers for Similar General Purposes - Part 1: General Requirements - Edition 2 - Issue Date 05/12/2011

IEC 60320-2-2:1998 (2nd Edition) used in conjunction with IEC 60320-1:2001 (2nd Edition)

EN 60320-2-2:1998 (2nd Edition) used in conjunction with EN 60320-2:2001

SYSTEM DESCRIPTION

Screw-In Terminals – This product is designed to be used in accordance with cords with rating no higher than that of the product itself. The nominal torque value for the terminal screws = 0.4Nm. The strain relief clamping screws should be tightened to 0.3Nm (2.65in-lbs).

INSERTION AND REMOVAL

It is essential for maintaining the service life of the product, specifically the locking blade and its locking properties that the following is adhered to.

Before inserting / removing the connector from a C13 socket, the locking blade mechanism must be disengaged by fully retracting the RED handle (Fig. 16.) (Fig. 17.).

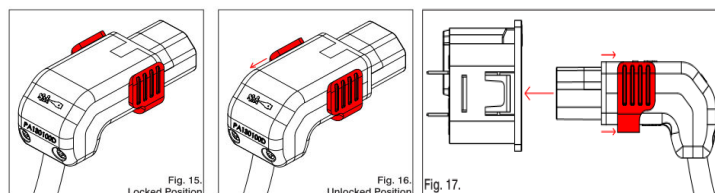

WebberElectronics®

38887 Taylor Pkwy, N. Ridgeville, OH 44039
440.327.7200

IECLock@WebberElectronics.com
WebberElectronics.com